

4

3

2

1

- NOTES:**
 1. MATERIAL: SEE COMPONENT SPECIFICATIONS.
 2. FINISH: AQUA-POLISH, BRIGHT-DIP OR EQUIVALENT.
 3. CLEAN: UNLESS OTHERWISE SPECIFIED, PER IN-HOUSE DOC. GAP-003.
 4. MARKING: UNLESS OTHERWISE SPECIFIED, PER IN-HOUSE DOC. ESR-005.
 REMOVE ALL BURRS & SHARP EDGES

REVISION HISTORY			
REV	DATE	E. C. O. / APPR.	NOTES
A	10-02-01	PLM.	DRAWING SHOWN VERSION A OF TA54-201 PART
B	11-11-11	HBS / PLM	ADDED SPLIT-RING TO ASSY. DETAIL

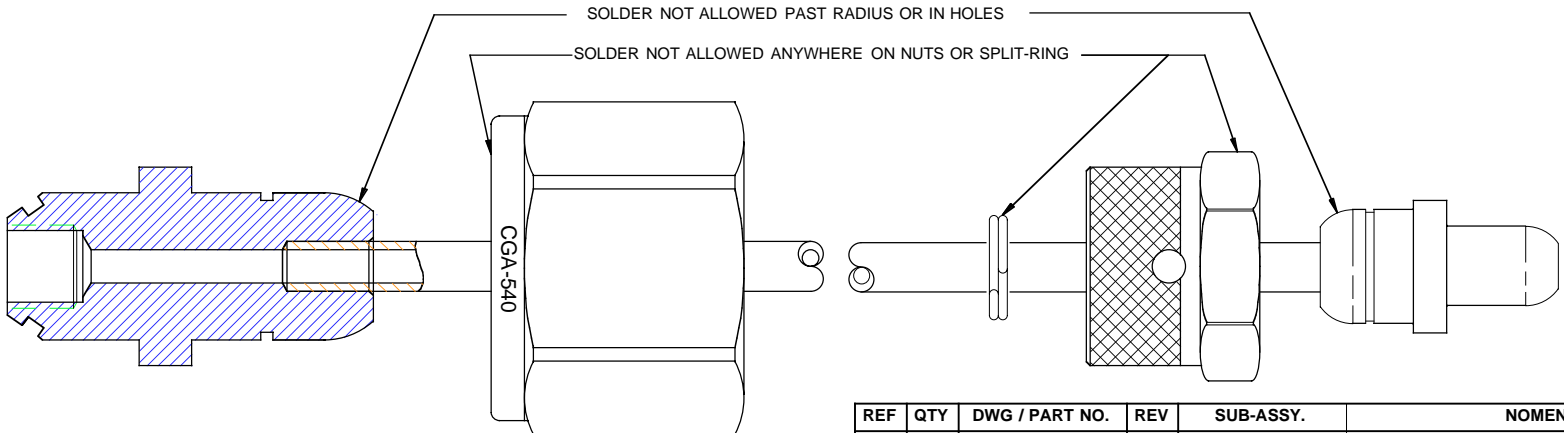
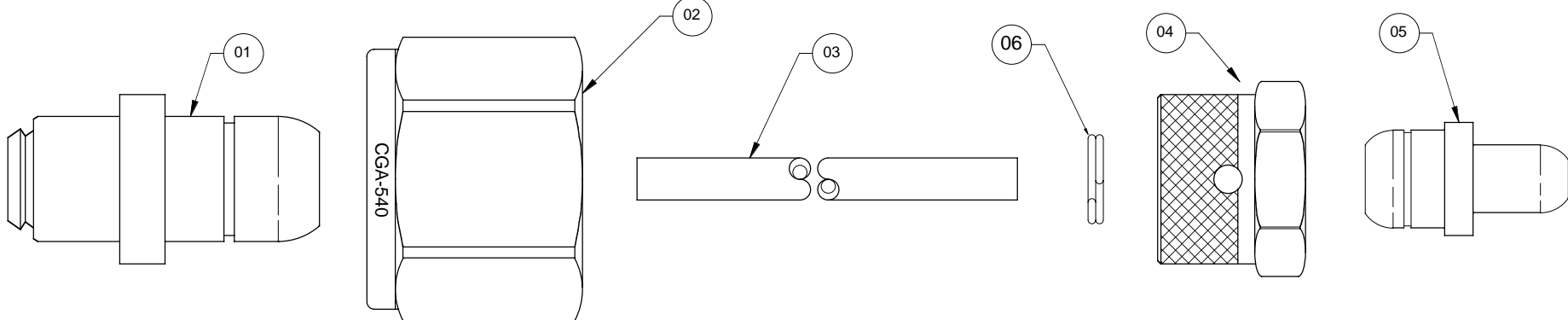

REF	QTY	DWG / PART NO.	REV	SUB-ASSY.	NOMENCLATURE
01	01	0TA54-205-000	A	-	FITTING, CGA-540 NIPPLE
02	01	00HDW-0358-00	-	-	NUT, CGA-540
03	01	19606-0003-16	-	-	TUBE, COPPER 3/16" OD X 8" LONG
04	01	0TA01-0201-00	-	-	NUT, HEX 9/16-18 (VENT)
05	01	0TA01-0203-00	-	-	FITTING, AS1219 (SCOTT, AIRLINE)
06	01	09004-0001-00	-	-	SPLIT-RING 0.380 X 0.288 X 0.068 BRASS

- ASSEMBLY NOTES:**
 A. BRAZE (SILVER SOLDER) TUBE (ITEM 03) TO FITTING (ITEM 01).
 B. ASSEMBLE NUT (ITEM 02) ON TUBE WITH THREADS FACING FITTING (ITEM 01).
 C. ASSEMBLE NUT (ITEM 04) ON TUBE WITH THREADS FACING FITTING (ITEM 05).
 D. BRAZE (SILVER SOLDER) TUBE TO FITTING (ITEM 05).
 E. ASSY. MUST BE FREE OF ALL POST BRAZING OXIDIZING BLEMMISHES BY FINISHING PROCESS

UNLESS OTHERWISE SPECIFIED DIMS ARE IN INCHES.
 TOLERANCES ARE:
 0.X ±0.015 ANGLES FRACTIONS 63
 0.XX ±0.010 ± 0.5° ± 1/64
 0.XXX ±0.005

INTERPRET GD&T PER ASME 14.5 FMT REV H

THIRD ANGLE PROJECTION
 DO NOT SCALE DRAWING

MOUNTAIN HIGH E&S CO. REDMOND, OR. USA
 [KC] 00 NUMBER OF KEY CHARACTERISTICS IN THIS DRAWING / DOCUMENT PER MH DOC: ESR-001

ORIGINAL MO-DA-YR	PLM, 11-24-99	MATERIAL	ASSY, TUBE: CGA540-N TO AS1219
ENGINEER MO-DA-YR	PLM, 11-24-99	FINISH	TA54-111-000
DRAWN MO-DA-YR	PLM, 11-24-99	CLEAN	TA54-540 SCOTT: -111 ASSY.
CHECKED MO-DA-YR	-	MARKING	

THIS DOCUMENT AND ALL TECHNICAL DATA HEREON DISCLOSED ARE PROPERTY OF MOUNTAIN HIGH E&S CO. AND SHALL NOT BE USED, RELEASED OR DISCLOSED IN WHOLE OR PART WITHOUT WRITTEN PERMISSION FROM MOUNTAIN HIGH E&S CO. THIS DOCUMENT MUST BE RETURNED TO MOUNTAIN HIGH E&S CO. IMMEDIATELY UPON REQUEST.

4

3

2

1