

**SPECIFICATIONS**

MATERIAL: BRASS, SS & Acrylic  
 MAX PRESSURE: 207 bar (3000 PSIG.)  
 OPERATING RANGE: 152 bar (0-2200 PSIG.)  
 SAFETY FACTOR: 3:1  
 REAR AXIAL PORT: 1/8 NPT-M  
 TEMP RANGE: -25°F TO 225°F  
 OEM VEN CODE: 1057

**REVISION HISTORY**

REV	DATE	E. C. O. / APPR.	NOTES
A	04-07-00	PLM	CHANGED TO NEW FORMAT
B	09-20-00	PLM	CHANGED TO SHOW PROPER DETAIL ON GAUGE
C	11-28-00	PLM	ADDED COLOR DETAIL ON GAUGE DIAL (WAS DWG. NO. E900130)

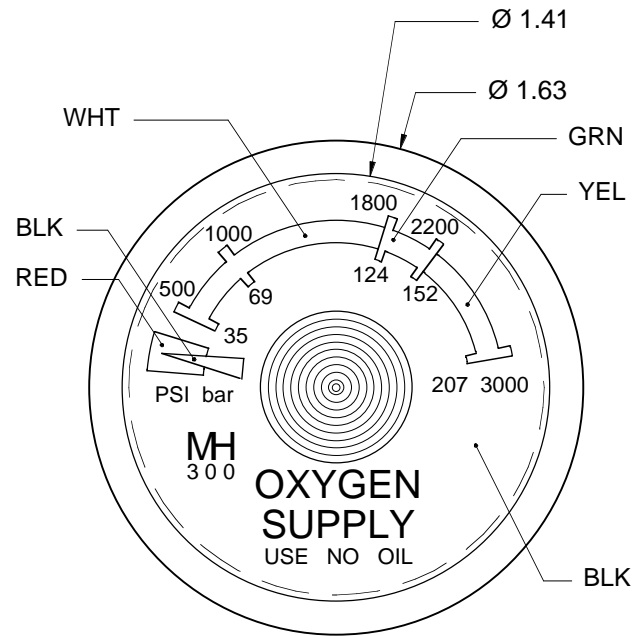

TEXT ON DIAL IS WHT ON BLK

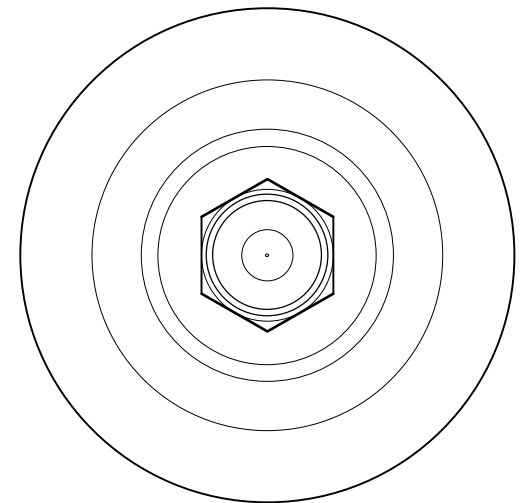
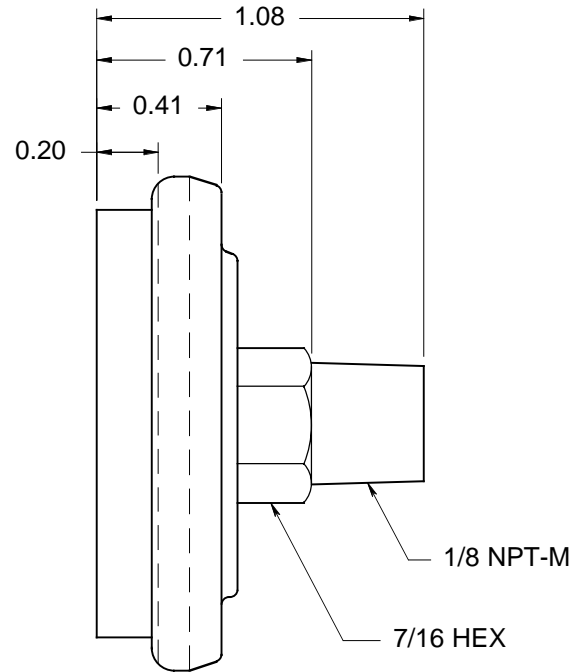

FOR REFERENCE ONLY

UNLESS OTHERWISE SPECIFIED DIMS ARE IN INCHES. TOLERANCES ARE:		THIRD ANGLE PROJECTION.	<CR> KEY CHARACTERISTICS	NO.
0.X ±0.015	ANGLES ±0.5°	FRACTIONS ±1/64	<MA> PER CORP. DOC: ESR-001	-
0.XX ±0.010			<b>MH</b> MOUNTAIN HIGH	
0.XXX ±0.005		63 ✓	E&S CO.	
INTERPRET GD&T DIMS AND TOLS PER ASME 14.5			REDMOND, OR. USA	
ISSUED:	04-26-96		GAUGE: 1.4" 1/8 NPT REAR-MOUNT	
DRAWN:	PLM	04-26-96	DWG. #: 9500-003	
ENGINEER:		DATE	REV C	
APPR:		DATE	SIZE A	SHEET 1 OF 1
DO NOT SCALE DRAWING				