

SPECIFICATIONS

MATERIAL: BRASS, SS & Acrylic
 MAX PRESSURE: 207 bar (3000 PSIG.)
 OPERATING RANGE: 152 bar (0-2200 PSIG.)
 SAFETY FACTOR: 3:1
 REAR AXIAL PORT: 1/8 NPT-M
 TEMP RANGE: -25°F TO 225°F
 OEM VEN CODE: 1057

REVISION HISTORY			
REV	DATE	E. C. O. / APPR.	NOTES
A	04-07-00	PLM	CHANGED TO NEW FORMAT
B	09-20-00	PLM	CHANGED TO SHOW PROPER DETAIL ON GAUGE
C	11-28-00	PLM	ADDED COLOR DETAIL ON GAUGE DIAL (WAS DWG. NO. E900130)
C1	2019-05-21	2019-021	Change Dwg #: was 9500-003, is 5SCPG-1010-00

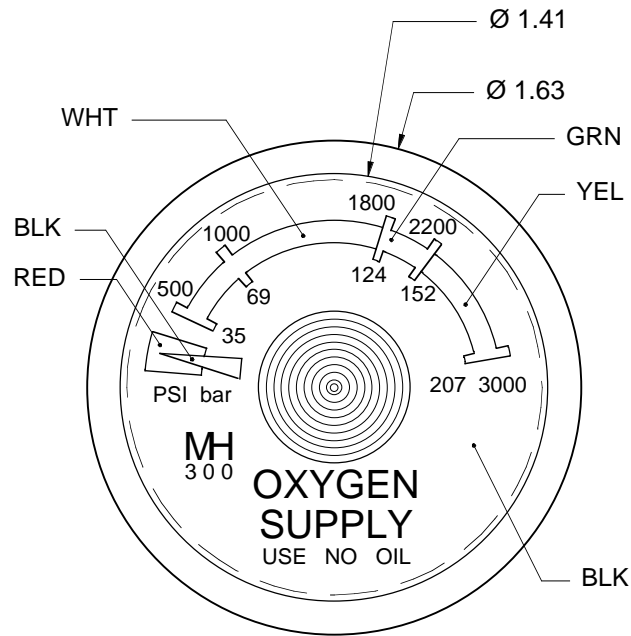

TEXT ON DIAL IS WHT ON BLK

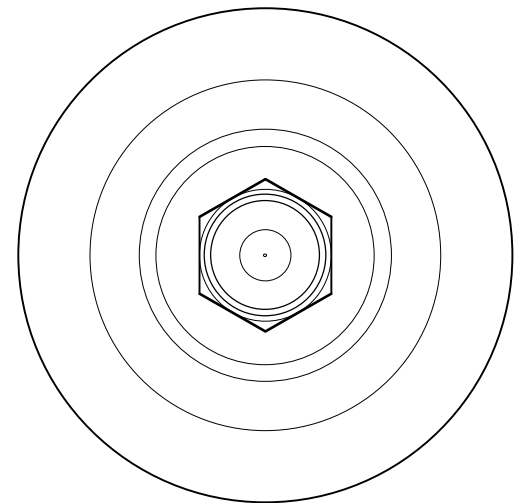
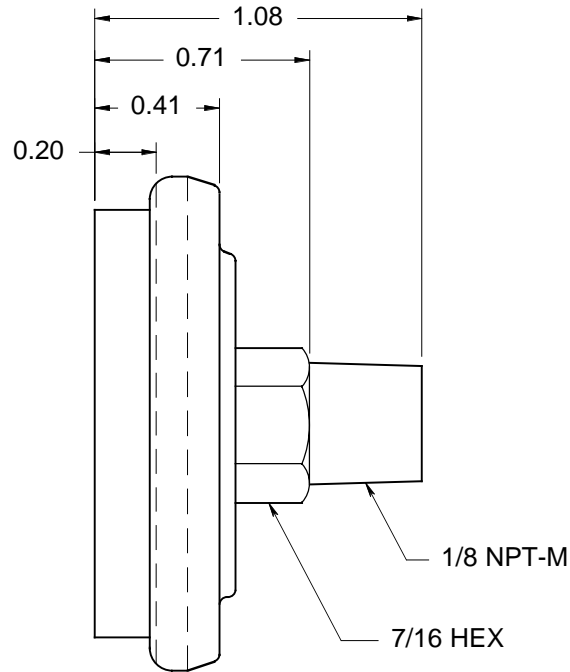

**MH-300 Pressure Gauge
 MH p/n 00CPG-1010-00**

UNLESS OTHERWISE SPECIFIED DIMS ARE IN INCHES. TOLERANCES ARE:		THIRD ANGLE PROJECTION.	<CR> KEY CHARACTERISTICS	NO.
0.X	±0.015	ANGLES ±0.5°	<MA> PER CORP. DOC: ESR-001	-
0.XX	±0.010	FRACTIONS ±1/64	MH MOUNTAIN HIGH E&S CO. REDMOND, OR. USA	GAUGE: 1.4" 1/8 NPT REAR-MOUNT
0.XXX	±0.005	63		
INTERPRET GD&T DIMS AND TOLS PER ASME 14.5			DWG. #: 5SCPG-1010-00	REV C1
ISSUED:	04-26-96		SIZE A	SHEET 1 OF 1
DRAWN:	PLM 04-26-96		DO NOT SCALE DRAWING	
ENGINEER:	DATE			
APPR:	DATE			