

- NOTES:**
 1. MATERIAL: (S30300) 303 STAINLESS STEEL.
 2. FINISH: NONE.
 3. CLEAN: UNLESS OTHERWISE SPECIFIED, PER AIR-1176A SEC. 5.
 4. MARKING: UNLESS OTHERWISE SPECIFIED, PER IN-HOUSE DOCUMENT ESR-005.

REMOVE ALL BURRS & SHARP EDGES

REVISION HISTORY			
REV	MO-DA-YR	E. C. O. / APPR.	NOTES
A	05-29-2014	HBS / PLM	ADDED BASIC SPECIFICATION NOTES

SPECIFICATION NOTES:

Service Pressure: 0 to 2216 psig. (1850 nominally)
 Cracking Pressure: 50 to 90 psid.
 Burst Pressure: 3000 psig.
 Operating Temp: -40 to +150 °F

ASSY REF DWG.

ASSEMBLY NOTES:

1. INSTALL VALVE CORE (ITEM 02) INTO VALVE BODY (ITEM 01). TORQUE TO 1.5-3.0 IN-LB.
2. APPLY TEST DATE AND INSPECTOR IDENTIFICATION.
3. INSTALL CAP & CHAIN ASSY (ITEM A1) ONTO VALVE (ITEM A2).
4. APPLY TEST DATE AND INSPECTOR IDENTIFICATION.

TESTING:

WITH CAP REMOVED, THE VALVE SHALL BE PRESSURIZED FROM OUTLET SIDE (1/8 NPT-M) TO 2100 PSIG MINIMUM. LEAKAGE NOT TO EXCEED 10 CC PER MINUTE. WITH CAP INSTALLED, THE VALVE PRESSURIZED TO 2100 PSIG AND SUBMERGED IN WATER, LEAKAGE SHALL NOT EXCEED 1 BUBBLE PER 30 MINUTES.

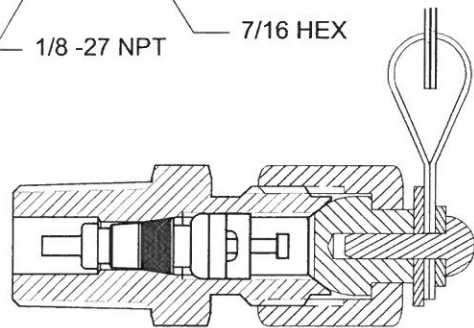
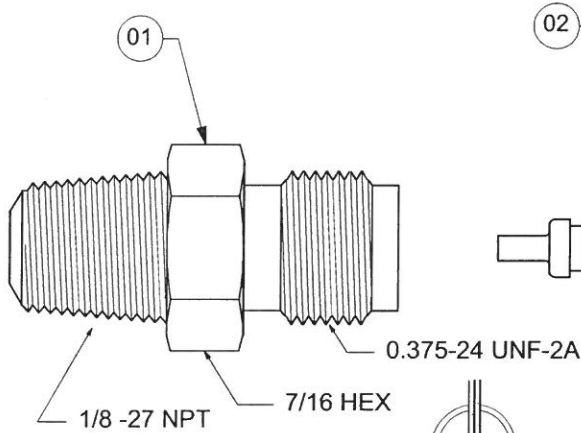

FINAL ASSEMBLY

REF	QTY	DWG / PART NO.	REV	SUB-ASSY.	NOMENCLATURE
01	01	CV01-251	-	-	BODY, CHECK-VALVE (MS-22066)
02	01	9080-302	-	-	CORE, VALVE (EATON 302-DV MIL-V-8965)
A1	01	-	-	CP01-100	ASSY, CAP & CHAIN (3/8-20 AN800-3)

UNLESS OTHERWISE SPECIFIED DIMS ARE IN INCHES. TOLERANCES ARE:

0.X ±0.015 ANGLES FRACTIONS 63/
 0.XX ±0.010 ± 0.5° ± 1/64
 0.XXX ±0.005

INTERPRET DIM AND TOL PER ASME 14.5

THIRD ANGLE PROJECTION.

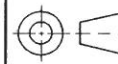

<CR> KEY CHARACTERISTICS PER CORP. DOC: ESR-001 NO. -0-

MH MOUNTAIN HIGH E&S CO. REDMOND, OR. USA

ISSUED:	11-01-99	MATERIAL:	NOTE 1	ASSY, CHECK-VALVE & CAP (SCD)
DRAWN:	TEM	FINISH:	NOTE 2	
ENGINEER:	PLM	CLEAN:	NOTE 3	DWG. #: CV01-100 (MS22066) REV A
APPR:	PLM	MARKING:	NOTE 4	SIZE A SHEET 1 OF 1 DO NOT SCALE DRAWING

P/N 00BLT-1008-00

1 5IBLT-1008-00