

4

3

2

1

- 1: +12 TO +32 VDC POWER INPUT
- 2: INTERNALLY CONNECTED TO PIN 1
- 3: +12 VDC OUT FOR 14V SENDING UNITS ONLY
- 4: N/C
- 5: INPUT (4 - 20 MA PRESSURE SENDING UNIT)
- 6: EL INTERNAL LIGHTING AC INPUT
- 7: EL INTERNAL LIGHTING AC INPUT
- 8: INTERNALLY CONNECTED TO PIN 9
- 9: GROUND

REVISION HISTORY			
REV	MO-DA-YR	E. C. O. / APPR.	NOTES
-	12-12-03	PLM	INITIAL RELEASE
A	10-06-11	PLM	UPGRADED DRAWING TO SHOW NEW GAUGE DETAILS

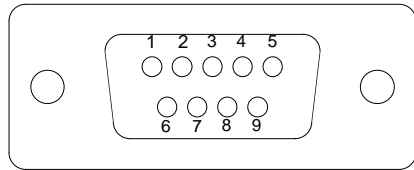

DE-09 CONNECTOR
on rear of both gauge types

**PIN ASSIGNMENTS ON
CURRENT RELEASE OF
EPG-600A & 601A
GAUGE UNITS**

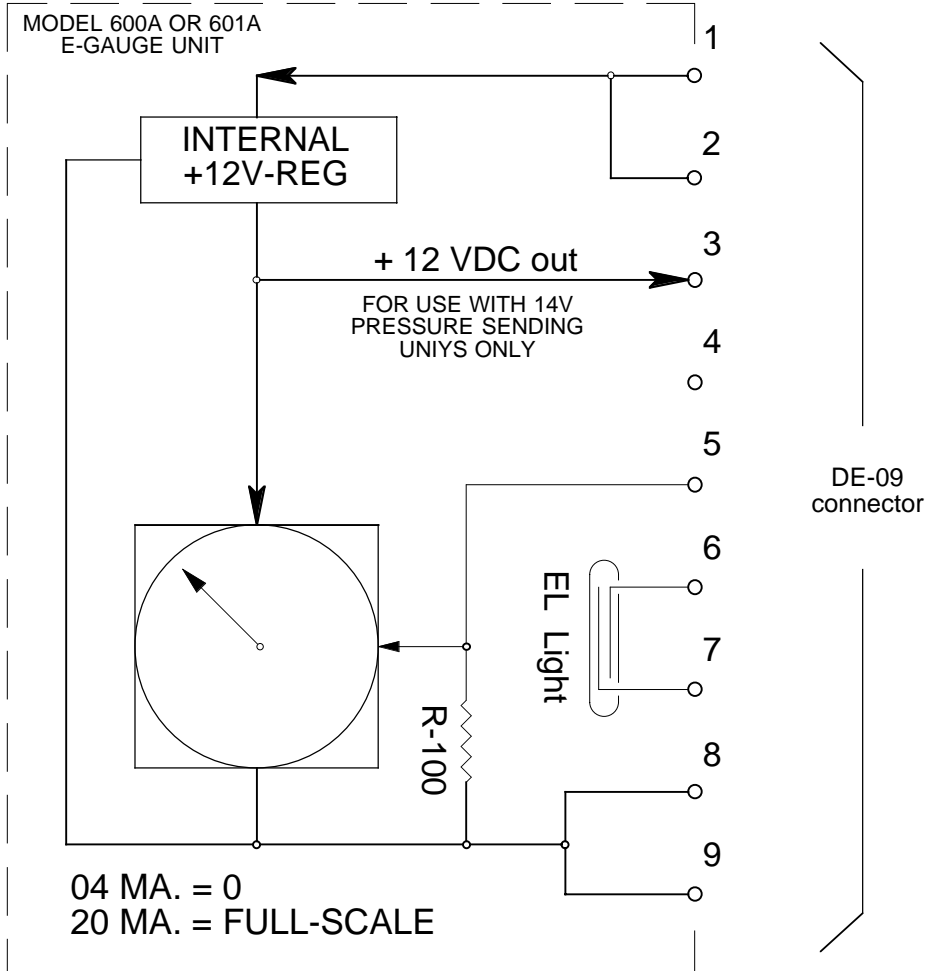
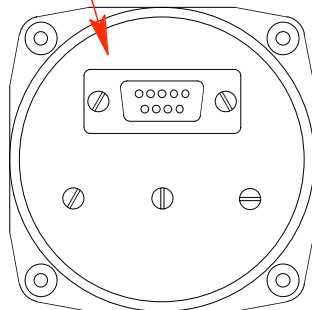
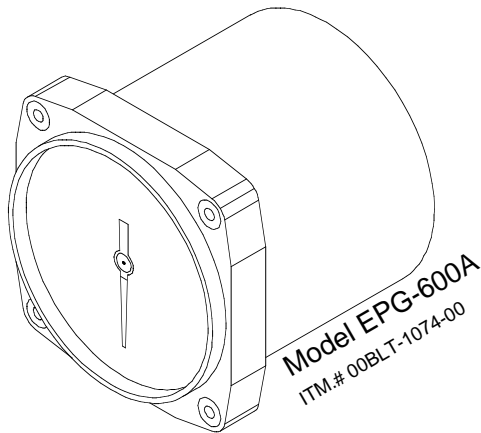
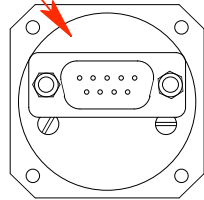
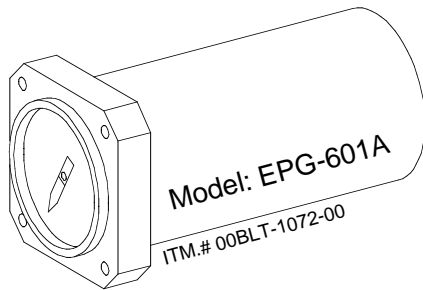

UNLESS OTHERWISE SPECIFIED DIMS ARE IN INCHES.
TOLERANCES ARE:

0.X	±0.015	ANGLES	FRACTIONS	63
0.XX	±0.010	± 0.5°	± 1/64	
0.XXX	±0.005			

INTERPRET GD&T PER ASME 14.5 FMT REV G

THIRD ANGLE
PROJECTION

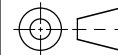

DO NOT SCALE
DRAWING



MOUNTAIN HIGH
E&S CO.
REDMOND, OR. USA

[KC]
00

NUMBER OF KEY CHARACTERISTICS
IN THIS DRAWING / DOCUMENT
PER MH DOC: ESR-001

ORIG.:	PLM	11-10-00	OXYGEN E-GAUGE, 1.5" FORM-FACTOR (SCD)	
DRWN.:	PLM	11-10-00	DWG. # 0EPG6-051-003	REV B SIZE A
ENG.:	PLM	11-10-00		
APPR.:	NAME	MO-DA-YR	SHEET 3 OF 3	