



## **KM100-1010-01 Fill Port Field Repair Kit**

Contents: Qty. 1 Retaining Snap Ring ①: 09007-0001-00  
Qty. 1 Check Valve Poppet ②: 0CV02-0201-00  
Qty. 2 Small EPDM O-Ring ③: 09001-3003-70  
Qty. 2 Large EPDM O-Ring ④: 09001-3904-80  
Qty. 1 Filter ⑥: 09150-0803-05

Tools Needed: small slotted screwdriver, fine point tweezers, compressed air (optimal but not required)

***Important: Take care to keep all internal parts and replacement parts as clean as possible.***

- Purge pressure from the system and remove the fill port from the assembly.
- Using fine point tweezers, remove the retaining snap ring ① from the SAE-4 end. A spare snap ring is provided in the repair kit in the event that the original is lost or compromised.
- Remove the check valve poppet ② with small o-ring ③ and set aside, protected from debris contamination. The repair kit contains a quick change poppet with the o-ring already installed as well as a second spare o-ring.
- With a small slotted screwdriver, unscrew the filter ⑥ from the AN-800 end of the fill port and replace with the new filter as needed. In some instances, simply clearing the existing filter of debris is sufficient. There is a flow restricting orifice under the filter in the chamber. This should not need to be removed but can be with the same slotted screwdriver, in the very unlikely event that it becomes plugged.
- Thoroughly blow out the fill port, from the filter end through, to remove any debris from the filter installation.
- Replace the o-ring ③ on the check valve poppet ② and install in the fill port ⑤ or install the quick change poppet assembly. Ensure that the o-ring and poppet are as free of debris and particulates as possible. **Debris on the poppet o-ring may cause a high pressure leak, compromising the seal, and damaging the o-ring.**
- Install the retaining snap ring ① into the radial groove along the inner wall of the check valve chamber. The ring should move freely in the groove when installed properly.
- Remove and replace the large o-ring ④ on the SAE-4 end. The repaired fill port is ready for service.

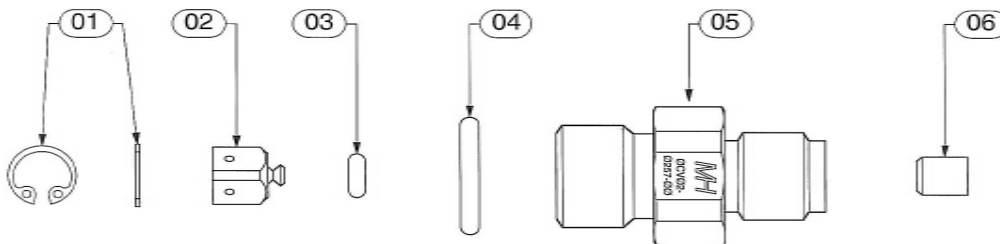

Maintenance: Unused – No action needed.

Moderate use in clean environment – Inspect at 6 months, replace internals at 12 months or as required.

Extreme use in dirty environment – Replace internals monthly or as required.



2244 SE Airport Way, Suite 100  
Redmond, OR 97756-7537 U.S.A.  
[www.MHoxxygen.com](http://www.MHoxxygen.com)

800-468-8185 / 541-923-4100  
Fax: 541-923-4141  
[sales@MHoxxygen.com](mailto:sales@MHoxxygen.com)