

1

2

3

4

GENERAL SPECIFICATIONS

Material: UNS C36000 (CDA-360) Brass

Weight: 3.9 oz [114 g]

Pressure Rating: 3000 PSIG

Temp Range: -50°F to +130°F [-45°C to +55°C]

Clean: For Oxygen Service

REV	ECO	Release	Drawn	REVISION HISTORY
D0	2016-061	2016-12-05	SGO	Customer Drawing

A

A

B

B

C

C

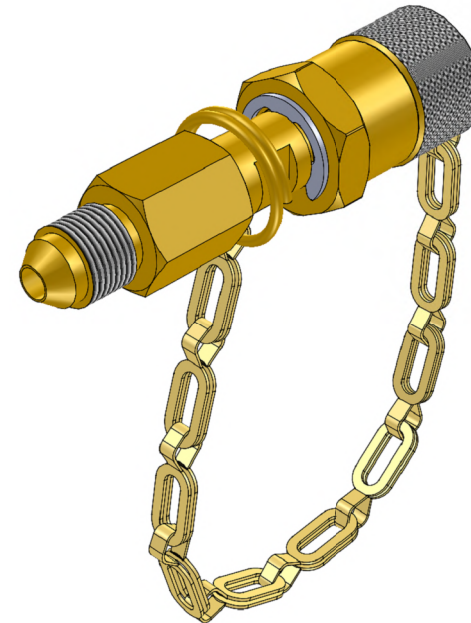
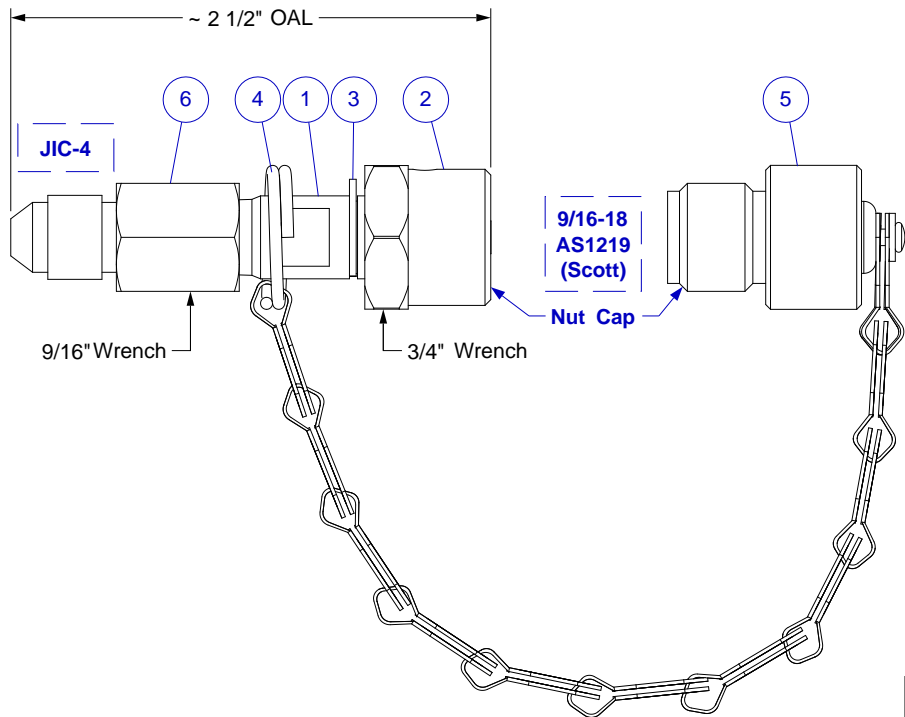

REF	Description
1	Adapter, 1/8 NPT to Scott
2	Scott 9/16-18 Nut
3	Retaining Ring
4	Split Ring
5	Plug & Chain Assy, Scott
6	Adapter, 1/8 NPT x JIC-4

D

D

UNLESS OTHERWISE SPECIFIED, DIMENSIONS ARE IN INCHES. TOLERANCES ARE:
 0.X ±0.015 ANGLES ± 3°
 0.XX ±0.010 FRACTIONS ± 1/64
 0.XXX ±0.005

INTERPRET GD&T PER ASME 14.5

MH MOUNTAIN HIGH E&S CO.
REDMOND, OR. USA

THIS DOCUMENT AND ALL TECHNICAL DATA HEREON DISCLOSED ARE PROPERTY OF MOUNTAIN HIGH E&S CO. AND SHALL NOT BE USED, RELEASED OR DISCLOSED IN WHOLE OR PART WITHOUT WRITTEN PERMISSION FROM MOUNTAIN HIGH E&S CO. THIS DOCUMENT MUST BE RETURNED TO MOUNTAIN HIGH E&S CO. IMMEDIATELY UPON REQUEST.

THIRD ANGLE PROJECTION	DRAWN SGO 2016-12-01	DWG TITLE Transfiller Adapter Assembly, JIC-4 to Scott 9/16-18 AS1219 [SCD]	
CHECKED	ENGINEER	DWG NUMBER 5SGSE-1043-02	DWG REV. DO
APPROVED	DWG FORMAT: ESR-002 Rev H [17]	INV. PART NUMBER 00GSE-1043-02	PROD. NAME Transfiller-Adapter JIC-4-To-9/16-Scott
DO NOT SCALE DRAWING	DWG SCALE	DWG SHEET 1 OF 1	DWG SIZE A 11x8½

1

2

3

Insert #: 5IGSE-1043-02