

THIS DOCUMENT AND ALL TECHNICAL DATA HEREON DISCLOSED ARE PROPERTY OF MOUNTAIN HIGH E&S CO. AND SHALL NOT BE USED, RELEASED OR DISCLOSED IN WHOLE OR PART WITHOUT WRITTEN PERMISSION FROM MOUNTAIN HIGH E&S CO. THIS DOCUMENT MUST BE RETURNED TO MOUNTAIN HIGH E&S CO. IMMEDIATELY UPON REQUEST.

REVISION HISTORY			
REV	DATE	E. C. O. / APPR.	NOTES
-	07-21-05	SBW	INITIAL RELEASE

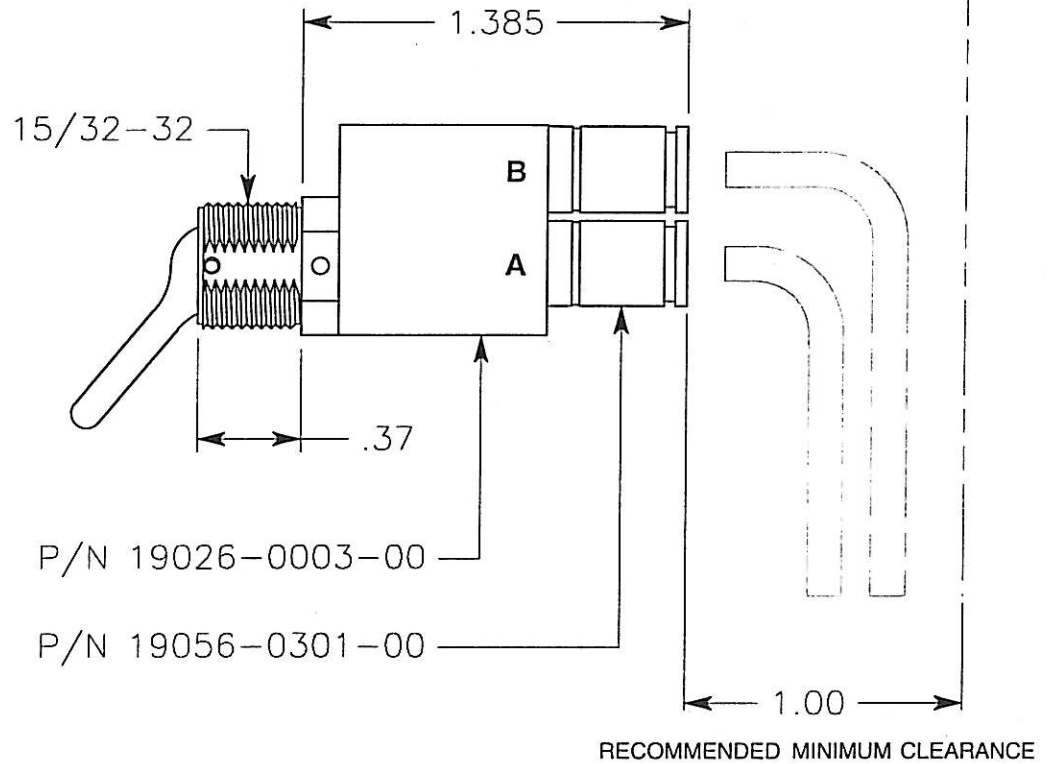
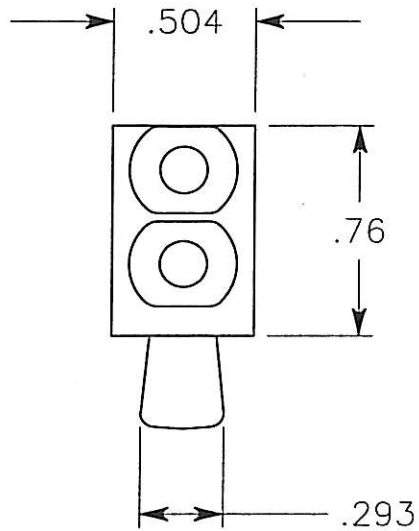

SWITCH SHOWN IN OFF POSITION

UNLESS OTHERWISE SPECIFIED DIMS ARE IN INCHES.				THIRD ANGLE PROJECTION	<CR> KEY CHARACTERISTICS	QTY
0.X ±0.010	ANGLES ±0.5°	FRACTIONS ± 1/64	53		<MA> PER CORP. DOC: ESR-001	-
0.XX ±0.005					MH MOUNTAIN HIGH E&S CO. REDMOND, OR. USA	
0.XXX ±0.002			(FMT REV A)			
INTERPRET GD&T PER ASME 14.5					PNEUMATIC SWITCH	
ISSUED:	DATE	MATERIAL:	NOTE 1	DWG. #:		
DRAWN:	DATE	FINISH:	NOTE 2	REV -		
ENGINEER:	DATE	CLEAN:	NOTE 3			
APPR:	DATE	MARKING:	NOTE 4	SIZE A	SHEET 1 OF 1	DO NOT SCALE DRAWING