

NOTES:

1. Weight: ~ 2.0 oz.
2. Inlet/Outlet fittings accept 6mm OD PolyUrethane Tubing (MH p/n 19600-0003-00)
3. See document 5IREG-0050-06 ("Inline Step-down Regulator Information Sheet") for performance characteristics and additional information.

UNLESS OTHERWISE SPECIFIED, DIMENSIONS ARE IN INCHES. TOLERANCES ARE:
 0.X ±0.015 ANGLES ±0.5°
 0.XX ±0.010 FRACTIONS ±1/64
 0.XXX ±0.005

63 ✓

INTERPRET GD&T PER ASME 14.5

THIRD ANGLE PROJECTION

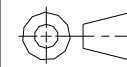

DO NOT SCALE DRAWING

DRAWN SGO
2013-12-18
CHECKED
ENGINEER
APPROVED

MOUNTAIN HIGH E&S CO. REDMOND, OR. USA		THIS DOCUMENT AND ALL TECHNICAL DATA HEREON DISCLOSED ARE PROPERTY OF MOUNTAIN HIGH E&S CO. AND SHALL NOT BE USED, RELEASED OR DISCLOSED IN WHOLE OR PART WITHOUT WRITTEN PERMISSION FROM MOUNTAIN HIGH E&S CO. THIS DOCUMENT MUST BE RETURNED TO MOUNTAIN HIGH E&S CO. IMMEDIATELY UPON REQUEST.	
		EDS Inline Regulator Assembly [SCD]	
5IREG-1110-00		INV. PART NUMBER 00REG-1110-00	PRODUCT NAME A1
DWG FORMAT: ESR-002 Rev H [13]		DWG SCALE	DWG SHEET 1 OF 1 DWG SIZE A